

209a

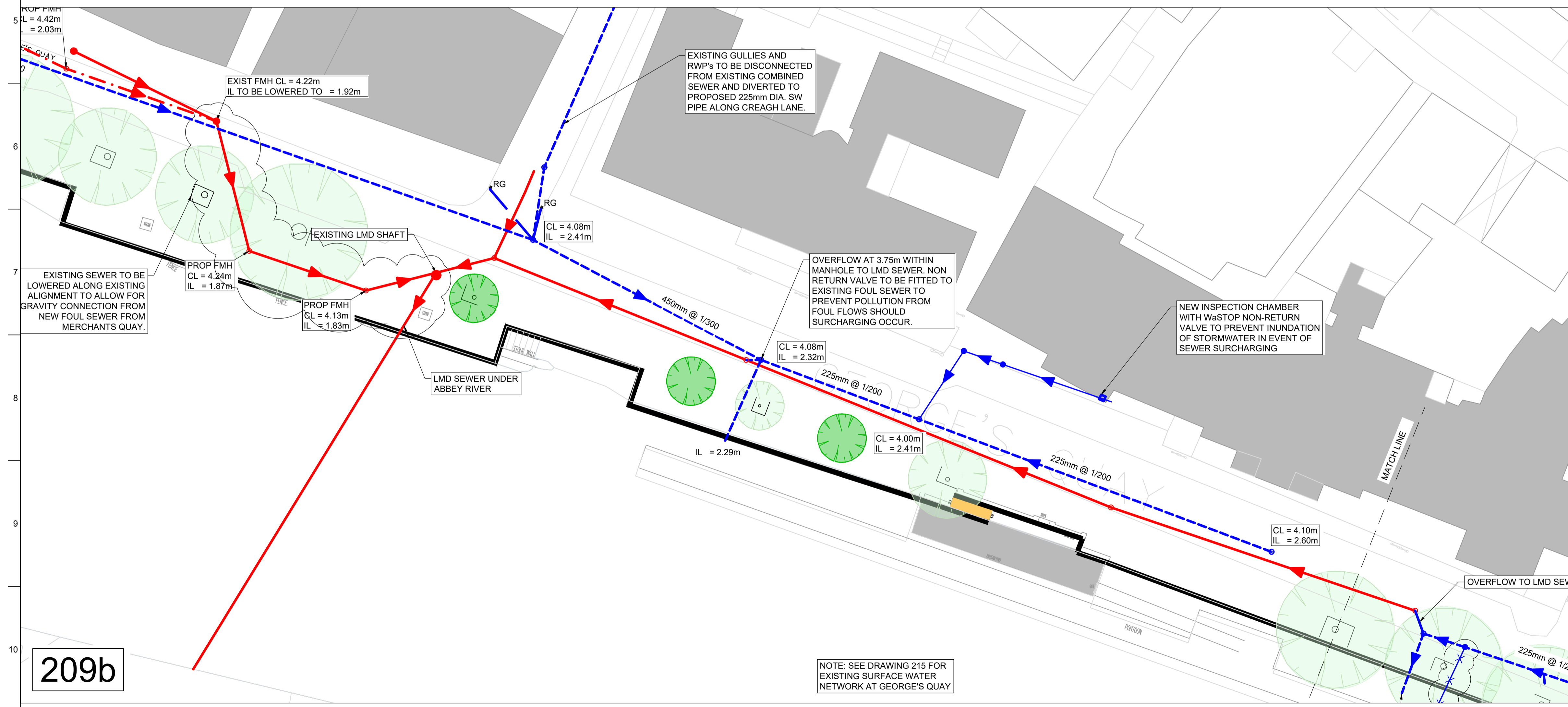

209b

NOTE: SEE DRAWING 215 FOR EXISTING SURFACE WATER NETWORK AT GEORGE'S QUAY

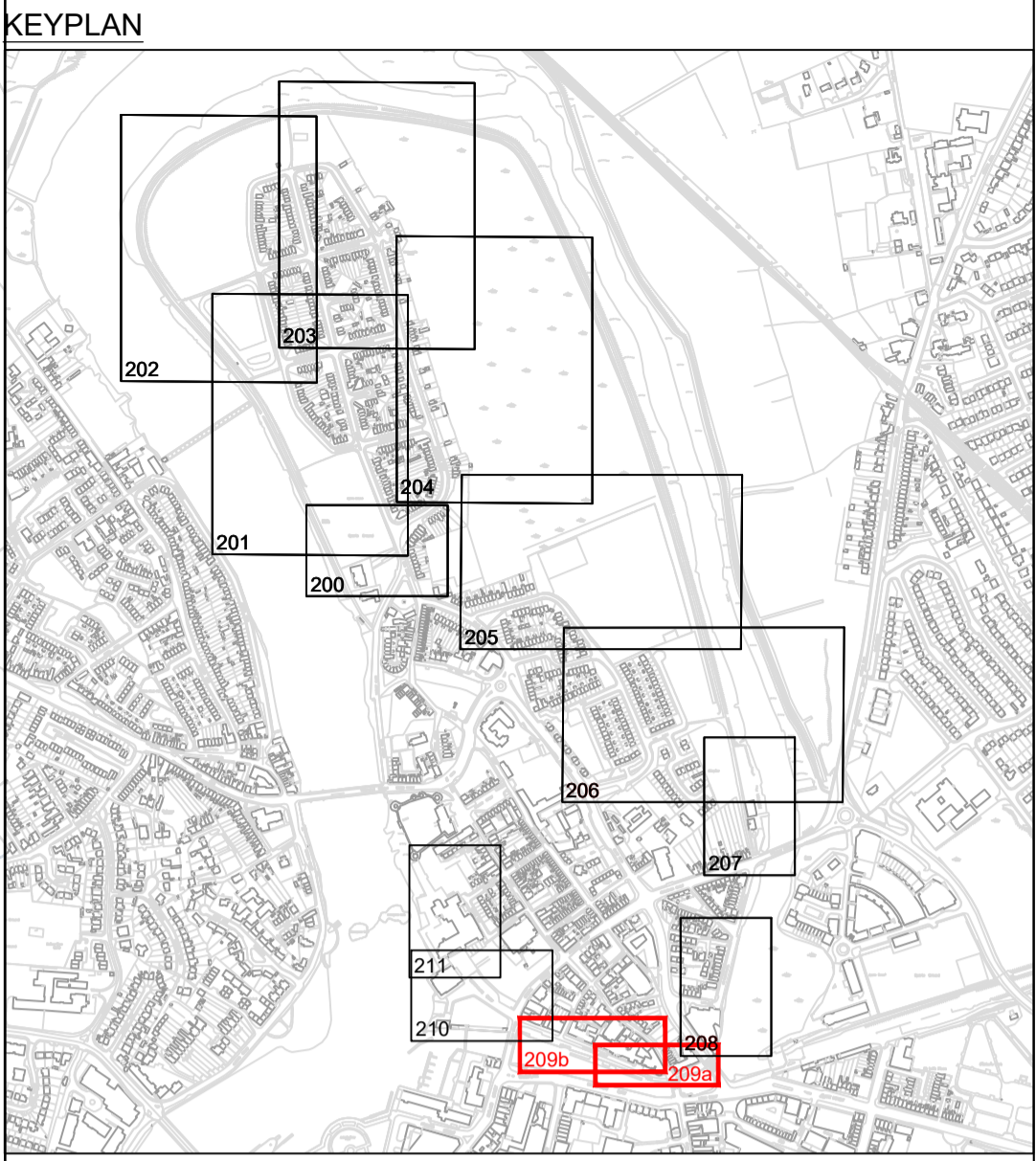

LEGEND

- EXISTING STORM MANHOLE
- EXISTING FOUL MANHOLE
- PROPOSED STORM MANHOLE
- PROPOSED FOUL MANHOLE
- IC PROPOSED INSPECTION CHAMBER
- EXISTING STORM SEWER
- EXISTING FOUL SEWER
- REDUNDANT SEWER
- EXISTING STORM SEWER TO BE REMOVED
- EXISTING FOUL SEWER TO BE REMOVED
- PROPOSED STORM SEWER
- PROPOSED FOUL SEWER
- PROPOSED FILTER DRAIN
- PROPOSED ACO CHANNEL
- PROPOSED FOUL RISING MAIN
- SURFACE CHANNEL/SWALE

JBA
consulting

Nicholas de Jong Associates
URBAN DESIGN

Issue	Date	By	Chkd	Appd

Client

Comhairle Cathrach & Contae Luimnigh
Limerick City & County Council

OPW
Oifig na hOibreachtas Poblai
Office of Public Works

Job Title

KING'S ISLAND
FLOOD RELIEF SCHEME

Scale at A1
1:250

Discipline
Infrastructure

ARUP

50 Ringsend Road,
Dublin 4, D04 R2K2, Ireland
t: +353 1 233 4455 f: +353 1 668 3169
www.arup.com

Drawing Title

Proposed Drainage Layout
Sheet 10 of 12

Job No
265545

Drawing Status
PLANNING

Drawing No
KIFRS-C-209

Issue
PL1